



Licensing and Regulatory Sub-Committee (Hearing)

Time and Date

10.00 am on Tuesday, 4th June, 2024

Place

Committee Room 3 - Council House

Public Business

1. **Appointment of Chair**
2. **Apologies**
3. **Declarations of Interest**
4. **Application for a Premises Licence under the Licensing Act 2003** (Pages 3 - 44)

To consider an application for a Premises Licence under the Licensing Act 2003 for Burger Boi, 48 Daventry Road, Coventry CV3 5DP

Note: The applicant and their representative have been invited to attend the hearing.

Persons who have made representations have been invited to attend.

The City Council's Statement of Licensing Policy is available on the Council's website. Alternatively, please contact us if you require a hard copy.

5. **Any Other Business**

To consider any other items of business which the Chair decides to take as a matter of urgency because of the special circumstances involved.

Private Business

Nil

Julie Newman, Director of Law and Governance, Council House, Coventry

Friday, 24 May 2024

Note: The person to contact about the agenda and documents for this meeting is

Usha Patel/Tom Robinson Email:

usha.patel@coventry.gov.uk/tom.robinson@coventry.gov.uk

Membership: Councillors F Abbott, S Gray and R Lakha

Public Access

Any member of the public who would like to attend the meeting in person is encouraged to contact the officer below in advance of the meeting regarding arrangements for public attendance. A guide to attending public meeting can be found here: <https://www.coventry.gov.uk/publicAttendanceMeetings>

Usha Patel/Tom Robinson

Email: usha.patel@coventry.gov.uk/tom.robinson@coventry.gov.uk



Licensing & Regulatory Sub-Committee

4th June 2024

Name of Cabinet Member:

Not applicable

Director Approving Submission of the report:

Director of Law and Governance

Ward(s) affected:

Cheylesmore

Title: Application for a Premises Licence under the Licensing Act 2003

Is this a key decision?

No

Executive Summary:

The purpose of this report is to consider an application for a Premises Licence under the Licensing Act 2003 for Burger Boi, 48 Daventry Road, Coventry CV3 5DP.

Recommendations:

The Sub-Committee is recommended to consider whether to:

1. Grant the application as requested.
2. Grant the application subject to such conditions that are necessary to promote the Licensing Objectives.
3. Refuse the application wholly or in part where it is necessary in order to promote the Licensing Objectives

List of Appendices included:

1. Premises Licence application
2. Plan
3. Representations x 2 & 1 petition.
4. Location Plan
5. Hearing Procedure Note
6. Relevant Hearing Briefing Note

Other useful background papers:

Section 182 Licensing Act 2003 Guidance

It is a statutory obligation of the Sub-Committee to take into account the Government's Guidance to the Licensing Act 2003 before reaching a decision.

Statement of Licensing Policy

The Council will have regard to the policy when making a decision on applications made under the Act.

Other Useful documents

None

Has it been or will it be considered by Scrutiny?

Not applicable

Has it been or will it be considered by any other Council Committee, Advisory Panel or other body?

No

Will this report go to Council?

Not applicable

1. Context (or background)

1.1 The Licensing Act 2003 requires Coventry City Council, as the Licensing Authority, to carry out its various licensing functions so as to promote the following four Licensing Objectives:

- The Prevention of crime & disorder
- The Protection of public safety
- The Prevention of public nuisance
- The Protection of children from harm

1.2 A Premises Licence application for Burger Boi, 48 Daventry Road, Coventry CV3 5DP was received on 15th March 2024. The application is requesting Late Night Refreshment, Monday - Sunday 23:00 – 00:00.

1.1 Three representations have been received (see Appendix 3). There are 2 representations from 'other' persons' and a petition containing 34 signatures (the petition was received electronically so the signatures are not included in the Appendices). The representations state that granting the application could undermine the following licensing objectives: Public Safety and the Prevention of Public Nuisance.

1.2 The Licensing Act 2003 requires the Council to publish a 'Statement of Licensing Policy' which sets out the policies the Council will have regard to and apply to promote the Licensing Objectives when making a decision on applications made under the Act. The Policy will be available at the hearing for reference purposes.

1.3 It is essential that the Sub-Committee takes into account the government's guidance to the Licensing Act before reaching a decision. The applicant, Responsible Authorities, or any other persons, should bring to the Sub-Committee's attention any relevant paragraphs. However, it is suggested good practice for Members of the Sub-Committee to read the relevant paragraph(s) of the guidance prior to the hearing.

2. Options considered and recommended proposal.

2.1 There are three courses of action available to the Sub-Committee in relation to this application:

- (i) Grant the application as requested. If the Sub-Committee consider that granting the application would not undermine any of the Licensing Objectives, it should be granted in full as submitted. This would be granted subject to mandatory conditions and conditions consistent with the applicant's operating schedule, and any other conditions agreed by the applicant as part of the consultation / mediation process. Any conditions to be attached to a licence must be appropriate to promote the Licensing Objectives.
- (ii) Grant the application as above, but the Sub-Committee could impose extra conditions as it thinks fit, or make amendments to the operating schedule conditions, and/or proposed hours. This option may include adding any conditions suggested by other parties at the hearing, including the applicant. Any conditions to be attached to a licence must be appropriate to promote the Licensing Objectives.
- (iii) If the Sub-Committee concludes that no additional conditions would ensure that the Licensing Objectives would be upheld, then the whole application should be rejected.

2.2 Your officer recommends option (i).

The reason for this recommendation is that other responsible authorities who responded to the consultation have not made representations or offered up further conditions.

2.3 The Sub-Committee are advised that they may depart from the officer recommendation if, having heard all the evidence, they believe it is appropriate to do so. Should the Sub-Committee decide to depart from the recommendation and choose an alternative option, they must provide full reasons for this decision, based on the promotion of the Licensing Objectives. This application should be considered on its own merits and all the circumstances taken into account before a decision is made.

2.4 The Sub-Committee must also be aware that a Premises Licence can be reviewed at any time by any Responsible Authority or any 'other person', if it is considered that any of the Licensing Objectives have been undermined following the grant of the Premises Licence.

3. Results of consultation undertaken

3.1 As prescribed by the Licensing Act 2003, the application has been out for consultation to statutory consultees for 28 days. The notice was displayed at the premises from 15th March 2024 until 12th April 2024 and was checked by the Licensing Officer on two occasions during the 28-day period. Licensing applications are also published weekly in the Members Bulletin which is available to Ward Councillors.

3.2 Responsible Authorities have received a copy of the application. Please see below responses received:

Responsible Authority	Response Received	Objections	Conditions Agreed
Licensing	Yes	No	No
Police	Yes	No	No
Environmental Protection	No	-	-
Fire Safety	No	-	-
Health & Safety	No	-	-
Trading Standards	Yes	No	No
Planning	No	-	-
Safeguarding Children	Yes	No	No
Public Health	No	-	-
Secretary of State	No	-	-

3.3 A mediation meeting is arranged for Tuesday 23 April; The outcome of this meeting will be reported at the hearing.

4. Timetable for implementing this decision.

4.1 The Appeal period is 21 days beginning on the date that the Appellant(s) receive notification of the decision of the Licensing Authority.

5. Comments from Director of Finance & Resources (Section 151 Officer) and Director of Law & Governance.

5.1 Financial implications

There are no financial implications arising directly from this report. However, there are possible cost implications if an appeal against the decision is made to the Magistrates Court

and the decision of the Sub-Committee is not upheld.

5.2 **Legal implications**

The Licensing Act 2003 sets out how applications for Premises Licences should be dealt with where valid representations have been submitted. The Sub-Committee have to decide the outcome of the application taking into account the four Licensing Objectives.

In accordance with the provisions of the Act, if a Licensing Authority rejects in whole or in part, an application to grant a Premises Licence, the applicant may appeal against the decision, to a Magistrates' court within 21 days of receiving notification of the decision.

Similarly, where a person who made relevant representations in relation to the application contends that the licence ought not to have been granted or that alternative or additional conditions should have been imposed on the licence, they may appeal against the decision, to a Magistrates' court within 21 days of receiving notification of the decision.

6. **Other implications**

6.1 **How will this contribute to achievement of the One Coventry Plan?**

It is the Regulatory Services team's responsibility to ensure that members of the public in Coventry are not put at risk. This contributes to the Council's core aim of ensuring that citizens live longer healthier lives. The business' failure to uphold the Licensing Objectives may have an adverse effect on Public Safety and citizen's quality of life. This aligns with the One Coventry Plan to work together to improve our city and the lives of those who live, work and study here.

6.2 **How is risk being managed?**

If the application is not handled in line with the Licensing Act 2003, there is a risk of judicial appeals, reviews and associated costs.

6.3 **What is the impact on the organisation?**

None

6.4 **Equalities / EIA**

This decision will not affect the service provision and therefore details of the Equalities Impact Assessment are not relevant in this case.

6.5 **Implications for (or impact on) climate change and the environment**

None

6.6 **Implications for partner organisations?**

The Council recognises that the licensing function is only one means of promoting delivery of the above objectives and should not therefore be seen as a means for solving all problems within the community. The Council will therefore continue to work with the West Midlands Police, Community Safety Partnership, local people, and those involved in child protection (Coventry Safeguarding Children Board) to promote the common objectives as outlined.

6.7 **Human Rights Act Implications**

None

Report author(s):

Name and job title:

Damon Blackburn, Licensing Officer.

Service: Street Scene and Regulatory Service

Telephone: 024 7697 2247

Email: damon.blackburn@coventry.gov.uk

Enquiries should be directed to the above person.

Contributor/approver name	Title	Service	Date doc sent out	Date response received or approved
Contributors:				
Thomas Robinson	Governance Services Officer	Law and Governance	24.04.2024	24.04.2024
Debbie Cahalin-Heath	Strategic Manager of Regulation & Communities	Regulatory Services	18.04.2024	23.04.2024
Davina Blackburn	Strategic Lead of Regulation & Communities	Regulatory Services	23.04.2024	23.04.2024
Names of approvers for submission: (officers and members)				
Amy Wright	Regulatory Lawyer	Law and Governance	24.04.2024	24.04.2024
Cath Crosby	Lead Accountant	Finance	24.04.2024	25.04.2024
Julie Newman	Director of Law and Governance	Legal & Governance Services	25.04.2024	25.04.2024

This report is published on the Council's website:

www.coventry.gov.uk/councilmeetings



Coventry City Council

Application for a premises licence to be granted under the Licensing Act 2003

Please read the following instructions first

Before completing this form please read the guidance notes at the end of the form. If you are completing this form by hand please write legibly in block capitals. In all cases ensure that your answers are inside the boxes and written in black ink. Use additional sheets if necessary.

You may wish to keep a copy of the completed form for your records.

I/We M T B Foods Limited

(Insert name(s) of applicant)

apply for a premises licence under section 17 of the Licensing Act 2003 for the premises described in Part 1 below (the premises) and I/we are making this application to you as the relevant licensing authority in accordance with section 12 of the Licensing Act 2003

Part 1 – Premises details

Postal address of premises or, if none, ordnance survey map reference or description			
Burger Boi 48 Daventry Road			
Post town	Coventry	Postcode	CV3 5DP

Telephone number at premises (if any)	07709 833881
Non-domestic rateable value of premises	£4301 - 33000

Part 2 - Applicant details

Please state whether you are applying for a premises licence as: **Please tick as appropriate**

a)	an individual or individuals *	<input type="checkbox"/>	please complete section (A)
b)	a person other than an individual *	<input type="checkbox"/>	
	i as a limited company/limited liability partnership	<input checked="" type="checkbox"/>	please complete section (B)
	ii as a partnership (other than limited liability)	<input type="checkbox"/>	please complete section (B)
	iii as an unincorporated association or	<input type="checkbox"/>	please complete section (B)
	iv other (for example a statutory corporation)	<input type="checkbox"/>	please complete section (B)
c)	a recognised club	<input type="checkbox"/>	please complete section (B)



Coventry City Council

d)	a charity	<input type="checkbox"/>	please complete section (B)
e)	the proprietor of an educational establishment	<input type="checkbox"/>	please complete section (B)
f)	a health service body	<input type="checkbox"/>	please complete section (B)
g) a	a person who is registered under Part 2 of the Care Standards Act 2000 (c14) in respect of an independent hospital in Wales	<input type="checkbox"/>	please complete section (B)
g) b	a person who is registered under Chapter 2 of Part 1 of the Health and Social Care Act 2008 (within the meaning of that Part) in an independent hospital in England	<input type="checkbox"/>	please complete section (B)
h)	the chief officer of police of a police force in England and Wales	<input type="checkbox"/>	please complete section (B)

* If you are applying as a person described in (a) or (b) please confirm (by ticking yes to one box below):

- I am carrying on or proposing to carry on a business which involves the use of the premises for licensable activities; or
- I am making the application pursuant to a
- statutory function or
- a function discharged by virtue of Her Majesty's prerogative

(A) individual applicants (fill in as applicable)

Mr <input type="checkbox"/>	Mrs <input type="checkbox"/>	Miss <input type="checkbox"/>	Ms <input type="checkbox"/>	Other Title (for example, Rev) <input type="checkbox"/>
Surname		First names		
Date of birth		I am 18 years old or over <input type="checkbox"/> Please tick yes		
Nationality				
Current residential address if different from premises address				
Post town		Postcode		
Daytime contact telephone number				
E-mail address				
Where applicable (if demonstrating a right to work via the Home Office online right to work checking service), the 'share code' provided to the applicant by that service (please see note 15 for information)				
Share Code:				



Coventry City Council

Second individual applicant (if applicable)

Mr <input type="checkbox"/>	Mrs <input type="checkbox"/>	Miss <input type="checkbox"/>	Ms <input type="checkbox"/>	Other Title (for example, Rev) <input type="checkbox"/>
Surname			First names	
Date of birth		I am 18 years old or over <input type="checkbox"/>		Please tick yes
Nationality				
Current residential address if different from premises address				
Post town		Postcode		
Daytime contact telephone number				
E-mail address				
Where applicable (if demonstrating a right to work via the Home Office online right to work checking service), the 'share code' provided to the applicant by that service: (please see note 15 for information)				
Share Code:				

(B) Other applicants

Please provide name and registered address of applicant in full. Where appropriate please give any registered number. In the case of a partnership or other joint venture (other than a body corporate), please give the name and address of each party concerned.

Name: M T B Foods Limited
Address: 5 The Quadrant Coventry CV1 2EL
Registered number (where applicable) 13624164



Coventry City Council

Description of applicant (for example, partnership, company, unincorporated association etc.) Limited Company
Telephone number (if any) 07709 833881
E-mail address (optional) mtbfoods@icloud.com

Part 3 Operating Schedule

When do you want the premises licence to start?

DD	MM	YYYY
<input type="text"/>	<input type="text"/>	<input type="text"/>

If you wish the licence to be valid only for a limited period, when do you want it to end?

DD	MM	YYYY
<input type="text"/>	<input type="text"/>	<input type="text"/>

Please give a general description of the premises (please read guidance note 1) Premises selling fast food.
--

If 5,000 or more people are expected to attend the premises at any one time, please state the number expected to attend.

What licensable activities do you intend to carry on from the premises?

(please see sections 1 and 14 and Schedules 1 and 2 to the Licensing Act 2003)

Provision of regulated entertainment (please read guidance note 2)		Please tick all that apply
a)	plays (if ticking yes, fill in box A)	<input type="checkbox"/>
b)	films (if ticking yes, fill in box B)	<input type="checkbox"/>
c)	indoor sporting events (if ticking yes, fill in box C)	<input type="checkbox"/>
d)	boxing or wrestling entertainment (if ticking yes, fill in box D)	<input type="checkbox"/>



Coventry City Council

e)	live music (if ticking yes, fill in box E)	<input type="checkbox"/>
f)	recorded music (if ticking yes, fill in box F)	<input type="checkbox"/>
g)	performances of dance (if ticking yes, fill in box G)	<input type="checkbox"/>
h)	anything of a similar description to that falling within (e), (f) or (g) (if ticking yes, fill in box H)	<input type="checkbox"/>
Provision of late night refreshment (if ticking yes, fill in box I)		<input checked="" type="checkbox"/>
Supply of alcohol (if ticking yes, fill in box J)		<input type="checkbox"/>

In all cases complete boxes K, L and M

A

Plays Standard days and timings (please read guidance note 7)			Will the performance of a play take place indoors or outdoors or both – please tick (please read guidance note 3)	Indoors	<input type="checkbox"/>
Day	Start	Finish		Outdoors	<input type="checkbox"/>
Mon			Please give further details here (please read guidance note 4)	Both	<input type="checkbox"/>
Tue					
Wed					
Thur			State any seasonal variations for performing plays (please read guidance note 5)		
Fri					
Sat					
Sun			Non standard timings. Where you intend to use the premises for the performance of plays at different times to those listed in the column on the left, please list (please read guidance note 6)		



Coventry City Council

B

Films Standard days and timings (please read guidance note 7)			Will the exhibition of films take place indoors or outdoors or both – please tick (please read guidance note 3)	Indoors	<input type="checkbox"/>			
				Outdoors	<input type="checkbox"/>			
				Both	<input type="checkbox"/>			
Day	Start	Finish	Please give further details here (please read guidance note 4)					
Mon								
Tue								
Wed						State any seasonal variations for the exhibition of films (please read guidance note 5)		
Thur								
Fri						Non standard timings. Where you intend to use the premises for the exhibition of films at different times to those listed in the column on the left, please list (please read guidance note 6)		
Sat								
Sun								



Coventry City Council

C

Indoor sporting events Standard days and timings (please read guidance note 7)			<u>Please give further details</u> (please read guidance note 4)
Day	Start	Finish	
Mon			
Tue			<u>State any seasonal variations for indoor sporting events</u> (please read guidance note 5)
Wed			
Thur			<u>Non standard timings. Where you intend to use the premises for indoor sporting events at different times to those listed in the column on the left, please list</u> (please read guidance note 6)
Fri			
Sat			
Sun			



Coventry City Council

D

Boxing or wrestling entertainments Standard days and timings (please read guidance note 7)			<u>Will the boxing or wrestling entertainment take place indoors or outdoors or both – please tick</u> (please read guidance note 3)	Indoors	<input type="checkbox"/>
				Outdoors	<input type="checkbox"/>
Day	Start	Finish		Both	<input type="checkbox"/>
Mon			<u>Please give further details here</u> (please read guidance note 4)		
Tue					
Wed			<u>State any seasonal variations for boxing or wrestling entertainment</u> (please read guidance note 5)		
Thur					
Fri			<u>Non standard timings. Where you intend to use the premises for boxing or wrestling entertainment at different times to those listed in the column on the left, please list</u> (please read guidance note 6)		
Sat					
Sun					



Coventry City Council

E

Live music Standard days and timings (please read guidance note 7)			<u>Will the performance of live music take place indoors or outdoors or both – please tick</u> (please read guidance note 3)	Indoors	<input type="checkbox"/>			
				Outdoors	<input type="checkbox"/>			
				Both	<input type="checkbox"/>			
Day	Start	Finish	<u>Please give further details here</u> (please read guidance note 4)					
Mon								
Tue								
Wed						<u>State any seasonal variations for the performance of live music</u> (please read guidance note 5)		
Thur								
Fri						<u>Non standard timings. Where you intend to use the premises for the performance of live music at different times to those listed in the column on the left, please list</u> (please read guidance note 6)		
Sat								
Sun								



Coventry City Council

F

Recorded music Standard days and timings (please read guidance note 7)			<u>Will the playing of recorded music take place indoors or outdoors or both – please tick</u> (please read guidance note 3)	Indoors	<input type="checkbox"/>			
				Outdoors	<input type="checkbox"/>			
				Both	<input type="checkbox"/>			
Day	Start	Finish	<u>Please give further details here</u> (please read guidance note 4)					
Mon								
Tue								
Wed						<u>State any seasonal variations for the playing of recorded music</u> (please read guidance note 5)		
Thur								
Fri						<u>Non standard timings. Where you intend to use the premises for the playing of recorded music at different times to those listed in the column on the left, please list</u> (please read guidance note 6)		
Sat								
Sun								



Coventry City Council

G

Performances of dance Standard days and timings (please read guidance note 7)			<u>Will the performance of dance take place indoors or outdoors or both – please tick</u> (please read guidance note 3)	Indoors	<input type="checkbox"/>
Day	Start	Finish		Outdoors	<input type="checkbox"/>
				Both	<input type="checkbox"/>
Mon			<u>Please give further details here</u> (please read guidance note 4)		
Tue					
Wed					
Thur			<u>State any seasonal variations for the performance of dance</u> (please read guidance note 5)		
Fri					
Sat					
Sun			<u>Non standard timings. Where you intend to use the premises for the performance of dance at different times to those listed in the column on the left, please list</u> (please read guidance note 6)		



Coventry City Council

H

Anything of a similar description to that falling within (e), (f) or (g) Standard days and timings (please read guidance note 7)			Please give a description of the type of entertainment you will be providing:		
Day	Start	Finish	<u>Will this entertainment take place indoors or outdoors or both – please tick</u> (please read guidance note 3)	Indoors	<input type="checkbox"/>
Mon				Outdoors	<input type="checkbox"/>
				Both	<input type="checkbox"/>
Tue			<u>Please give further details here</u> (please read guidance note 4)		
Wed					
Thur					
Fri			<u>State any seasonal variations for entertainment of a similar description to that falling within (e), (f) or (g)</u> (please read guidance note 5)		
Sat					
Sun					
			<u>Non standard timings. Where you intend to use the premises for the entertainment of a similar description to that falling within (e), (f) or (g) at different times to those listed in the column on the left, please list</u> (please read guidance note 6)		



Coventry City Council

I

Late night refreshment Standard days and timings (please read guidance note 7)			Will the provision of late night refreshment take place indoors or outdoors or both – please tick (please read guidance note 3)	Indoors	<input type="checkbox"/>
				Outdoors	<input type="checkbox"/>
				Both	<input checked="" type="checkbox"/>
Day	Start	Finish			
Mon	23:00	00:00	<u>Please give further details here</u> (please read guidance note 4)		
Tue	23:00	00:00			
Wed	23:00	00:00	<u>State any seasonal variations for the provision of late night refreshment</u> (please read guidance note 5)		
Thurs	23:00	00:00			
Fri	23:00	00:00	<u>Non standard timings. Where you intend to use the premises for the provision of late night refreshment at different times, to those listed in the column on the left, please list</u> (please read guidance note 6)		
Sat	23:00	00:00			
Sun	23:00	00:00			



Coventry City Council

J

Supply of alcohol Standard days and timings (please read guidance note 7)			Will the supply of alcohol be for consumption – please tick (please read guidance note 8)	On the premises	<input type="checkbox"/>
				Off the premises	<input type="checkbox"/>
				Both	<input type="checkbox"/>
Day	Start	Finish	State any seasonal variations for the supply of alcohol (please read guidance note 5)		
Mon					
Tue					
Wed					
Thur					
Fri					
Sat					
Sun					
			Non standard timings. Where you intend to use the premises for the supply of alcohol at different times to those listed in the column on the left, please list (please read guidance note 6)		

State the name and details of the individual whom you wish to specify on the licence as designated premises supervisor (Please see declaration about the entitlement to work in the checklist at the end of the form):

Name:	
Date of birth:	
Address:	
Postcode	
Personal licence number (if known):	
Issuing licensing authority (if known):	



Coventry City Council

M Describe the steps you intend to take to promote the four licensing objectives:

a) General – all four licensing objectives (b, c, d and e) (please read guidance note 10)

None.

b) The prevention of crime and disorder

CCTV will be in operation inside & outside, there will always be at least 1 member of staff on duty who can operate the CCTV to enable playback. CCTV recording will be retained for a minimum of 28 days.

CCTV footage will be provided to RA's within 48hours of a request, the exception being serious disorder or serious injury in which case its production may be required ASAP.

Burglar Alarm installed.

Roller shutters to frontage.

c) Public safety

Regular inspections of all fire alarms/fire equipment and escape routes.

First aid equipment and training for all staff, environmental protection duty of care (waste disposal).

Hygiene & safe handling of all food. Health and safety at work act 1974 to observed by taking steps for the safety of employees, customers, visitors.

Keeping a health and safety risk assessment, accident book hazard analysis.

d) The prevention of public nuisance

A regular inspection to the outside area will be conducted to remove any discarded refuse.

Waste Bins provided inside & outside.

Clear and prominent notices shall be displayed asking customers to be respectful of neighbouring properties by keeping noise to a minimum when leaving the premises.

Noise Management Plan.

e) The protection of children from harm

No children to be permitted access after 23:00 unless accompanied by a responsible adult.

All staff to be trained in basic licensing laws and child sexual exploitation. This is to be documented and refreshed on a 12 monthly basis.



Coventry City Council

Checklist:

Please tick to indicate agreement

•	I have made or enclosed payment of the fee.	<input checked="" type="checkbox"/>
•	I have enclosed the plan of the premises.	<input checked="" type="checkbox"/>
•	I have sent copies of this application and the plan to responsible authorities and others where applicable.	<input checked="" type="checkbox"/>
•	I have enclosed the consent form completed by the individual I wish to be designated premises supervisor, if applicable.	<input type="checkbox"/>
•	I understand that I must now advertise my application.	<input checked="" type="checkbox"/>
•	I understand that if I do not comply with the above requirements my application will be rejected. [Applicable to all individual applicants, including those in a partnership which is not a limited liability partnership, but not companies or limited liability partnerships] I have included documents demonstrating my entitlement to work in the United Kingdom or my share code issued by the Home Office online right to work checking service (please read note 15).	<input checked="" type="checkbox"/> <input type="checkbox"/>

It is an offence, under Section 158 of the Licensing Act 2003, to make a false statement in or in connection with this application. Those who make a false statement may be liable on summary conviction to a fine of any amount.

It is an offence under Section 24b of the Immigration Act 1971 for a person to work when they know, or have reasonable cause to believe, that they are disqualified from doing so by reason of their immigration status. Those who employ an adult without leave or who is subject to conditions as to employment will be liable to a civil penalty under section 15 of the Immigration, Asylum and Nationality Act 2006 and pursuant to Section 21 of the same act, will be committing an offence where they do so in the knowledge, or with reasonable cause to believe, that the employee is disqualified.

Part 4 – Signatures (please read guidance note 11)

Signature of applicant or applicant’s solicitor or other duly authorised agent (see guidance note 12). **If signing on behalf of the applicant, please state in what capacity.**

Declaration	<ul style="list-style-type: none"> • [Applicable to individual applicants only, including those in a partnership which is not a limited liability partnership] I understand I am not entitled to be issued with a licence if I do not have the entitlement to live and work in the UK (or if I am subject to a condition preventing me from doing work relating to the carrying on of a licensable activity) and that my licence will become invalid if I cease to be entitled to live and work in the UK (please read guidance note 15). • The DPS named in this application form is entitled to work in the UK (and is not subject to conditions preventing him or her from doing work relating to a licensable activity) and I have seen a copy of his or her proof of entitlement to work, or have conducted an online right to work check using the Home Office online right to work checking service which confirmed their right to work (please see note 15)
Signature	Mandeep Kahlon
Date	12/03/24
Capacity	Manager



Coventry City Council

For joint applications, signature of 2nd applicant or 2nd applicant’s solicitor or other authorised agent (please read guidance note 13). If signing on behalf of the applicant, please state in what capacity.

Signature	
Date	
Capacity	

Contact name (where not previously given) and postal address for correspondence associated with this application (please read guidance note 14)			
Post town		Postcode	
Telephone number (if any)			
Email Address			

Notes for Guidance

- Describe the premises, for example the type of premises, its general situation and layout and any other information which could be relevant to the licensing objectives. Where your application includes off-supplies of alcohol and you intend to provide a place for consumption of these off-supplies, you must include a description of where the place will be and its proximity to the premises.
- In terms of specific regulated entertainments please note that:
 - Plays: no licence is required for performances between 08:00 and 23.00 on any day, provided that the audience does not exceed 500.
 - Films: no licence is required for ‘not-for-profit’ film exhibition held in community premises between 08.00 and 23.00 on any day provided that the audience does not exceed 500 and the organiser (a) gets consent to the screening from a person who is responsible for the premises; and (b) ensures that each such screening abides by age classification ratings.
 - Indoor sporting events: no licence is required for performances between 08.00 and 23.00 on any day, provided that the audience does not exceed 1000.
 - Boxing or Wrestling Entertainment: no licence is required for a contest, exhibition or display of Greco-Roman wrestling, or freestyle wrestling between 08.00 and 23.00 on any day, provided that the audience does not exceed 1000. Combined fighting sports – defined as a contest, exhibition or display which combines boxing or wrestling with one or more martial arts – are licensable as a boxing or wrestling entertainment rather than an indoor sporting event.
 - Live music: no licence permission is required for:
 - a performance of unamplified live music between 08.00 and 23.00 on any day, on any premises.
 - a performance of amplified live music between 08.00 and 23.00 on any day on premises authorised to sell alcohol for consumption on those premises, provided that the audience does not exceed 500.
 - a performance of amplified live music between 08.00 and 23.00 on any day, in a workplace that is not licensed to sell alcohol on those premises, provided that the audience does not exceed 500.
 - a performance of amplified live music between 08.00 and 23.00 on any day, in a church hall, village hall, community hall, or other similar community premises, that is not licensed by a premises licence to sell alcohol, provided that (a) the audience does



Coventry City Council

- not exceed 500, and (b) the organiser gets consent for the performance from a person who is responsible for the premises.
 - a performance of amplified live music between 08.00 and 23.00 on any day, at the non-residential premises of (i) a local authority, or (ii) a school, or (iii) a hospital, provided that (a) the audience does not exceed 500, and (b) the organiser gets consent for the performance on the relevant premises from: (i) the local authority concerned, or (ii) the school or (iii) the health care provider for the hospital.
 - Recorded Music: no licence permission is required for:
 - any playing of recorded music between 08.00 and 23.00 on any day on premises authorised to sell alcohol for consumption on those premises, provided that the audience does not exceed 500.
 - any playing of recorded music between 08.00 and 23.00 on any day, in a church hall, village hall, community hall, or other similar community premises, that is not licensed by a premises licence to sell alcohol, provided that (a) the audience does not exceed 500, and (b) the organiser gets consent for the performance from a person who is responsible for the premises.
 - any playing of recorded music between 08.00 and 23.00 on any day, at the non-residential premises of (i) a local authority, or (ii) a school, or (iii) a hospital, provided that (a) the audience does not exceed 500, and (b) the organiser gets consent for the performance on the relevant premises from: (i) the local authority concerned, or (ii) the school proprietor or (iii) the health care provider for the hospital.
 - Dance: no licence is required for performances between 08.00 and 23.00 on any day, provided that the audience does not exceed 500. However, a performance which amounts to adult entertainment remains licensable.
 - Cross activity exemptions: no licence is required between 08.00 and 23.00 on any day, with no limit on audience size for:
 - any entertainment taking place on the premises of the local authority where the entertainment is provided by or on behalf of the local authority;
 - any entertainment taking place on the hospital premises of the health care provider where the entertainment is provided by or on behalf of the health care provider;
 - any entertainment taking place on the premises of the school where the entertainment is provided by or on behalf of the school proprietor; and
 - any entertainment (excluding films and a boxing or wrestling entertainment) taking place at a travelling circus, provided that (a) it takes place within a moveable structure that accommodates the audience, and (b) that the travelling circus has not been located on the same site for more than 28 consecutive days.
3. Where taking place in a building or other structure please tick as appropriate (indoors may include a tent).
 4. For example the type of activity to be authorised, if not already stated, and give relevant further details, for example (but not exclusively) whether or not music will be amplified or unamplified.
 5. For example (but not exclusively), where the activity will occur on additional days during the summer months.
 6. For example (but not exclusively), where you wish the activity to go on longer on a particular day e.g. Christmas Eve.
 7. Please give timings in 24 hour clock (e.g. 16.00) and only give details for the days of the week when you intend the premises to be used for the activity.
 8. If you wish people to be able to consume alcohol on the premises, please tick 'on the premises'. If you wish people to be able to purchase alcohol to consume away from the premises, please tick 'off the premises'. If you wish people to be able to do both, please tick 'both'.
 9. Please give information about anything intended to occur at the premises or ancillary to the use of the premises which may give rise to concern in respect of children, regardless of whether you intend children to have access to the premises, for example (but not exclusively) nudity or semi-nudity, films for restricted age groups or the presence of gaming machines.
 10. Please list here steps you will take to promote all four licensing objectives together.
 11. The application form must be signed.
 12. An applicant's agent (for example solicitor) may sign the form on their behalf provided that they have actual authority to do so.



Coventry City Council

13. Where there is more than one applicant, each of the applicants or their respective agent must sign the application form.
14. This is the address which we shall use to correspond with you about this application.
15. Entitlement to work/immigration status for individual applicants and applications from partnerships which are not limited liability partnerships:

A licence may not be issued to an individual or an individual in a partnership which is not a limited liability partnership who is resident in the UK who:

- does not have the right to live and work in the UK; or
- is subject to a condition preventing him or her from doing work relating to the carrying on of a licensable activity.

Any licence issued in respect of an application made on or after 6 April 2017 will become invalid if the holder ceases to be entitled to work in the UK.

Applicants must demonstrate that they have the right to work in the UK and are not subject to a condition preventing them from doing work relating to the carrying on of a licensable activity.

They do this in one of two ways:

- 1) by providing with this application, copies or scanned copies of the documents which an applicant has provided, to demonstrate their entitlement to work in the UK (which do not need to be certified) as per information published on gov.uk and in guidance.
- 2) by providing their 'share code' to enable the licensing authority to carry out a check using the Home Office online right to work checking service (see below).

Home Office online right to work checking service.

As an alternative to providing a copy of original documents, applicants may demonstrate their right to work by allowing the licensing authority to carry out a check with the Home Office online right to work checking service.

To demonstrate their right to work via the Home Office online right to work checking service, applicants should include in this application their share code (provided to them upon accessing the service at <https://www.gov.uk/prove-right-to-work>) which, along with the applicant's date of birth, will allow the licensing authority to carry out the check.

In order to establish the applicant's right to work, the check will need to indicate that the applicant is allowed to work in the United Kingdom and is not subject to a condition preventing them from doing work relating to the carrying on of a licensable activity.

An online check will not be possible in all circumstances because not all applicants will have an immigration status that can be shared digitally. The Home Office online right to work checking service sets out what information and/or documentation applicants will need in order to access the service. Applicants who are unable to obtain a share code from the service should submit copies of documents as set out above.

Your right to work will be checked as part of your licensing application and this could involve us checking your immigration status with the Home Office. We may otherwise share information with the Home Office. Your licence application will not be determined until you have complied with this guidance.

Ground Floor Plan

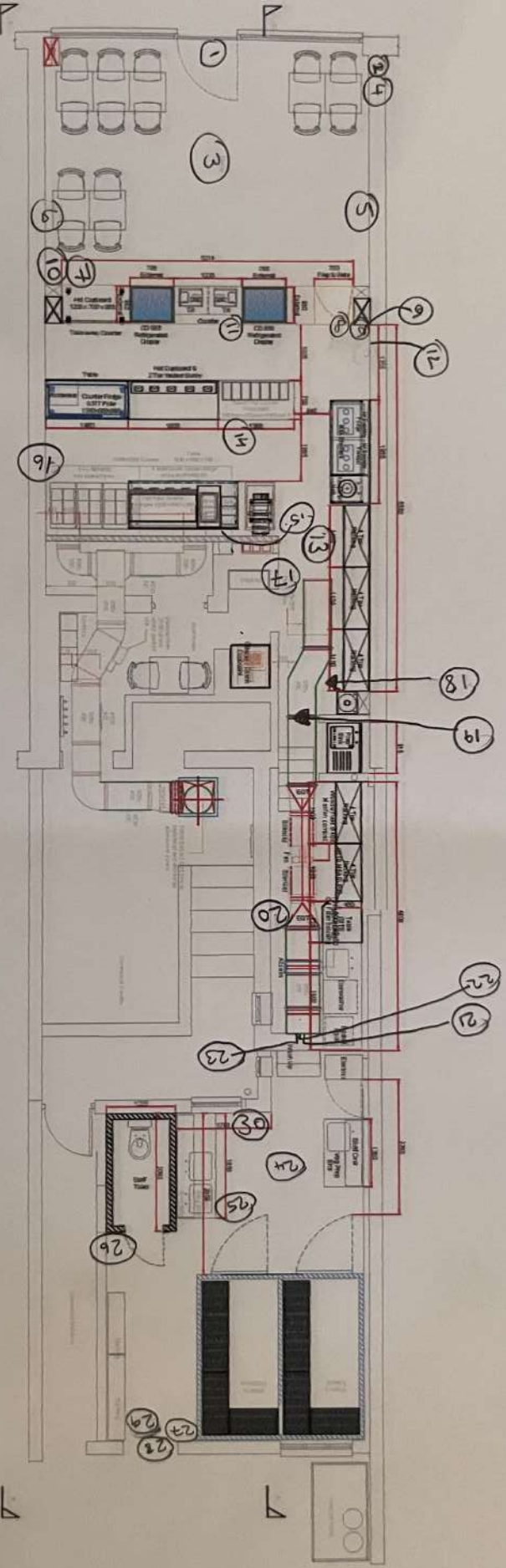

- ① - Fire exit
- ② - Fire Alarm main unit
- ③ - Smoke Alarm
- ④ - Leo Fire Alarm control
- ⑤ - Fire exit sign
- ⑥ - Fire exit sign
- ⑦ - CCTV Camera
- ⑧ - CCTV Camera
- ⑨ - Security Alarm sensor
- ⑩ - Security Alarm sensor
- ⑪ - CCTV camera
- ⑫ - Gas shut off emergency button
- ⑬ - CCTV camera
- ⑭ - Smoke Alarm
- ⑮ - Fire Blanket
- ⑯ - Fire Blanket
- ⑰ - Gas shut off emergency button
- ⑱ - Fire extinguishers x 2
- ⑲ - Fire exit sign
- ⑳ - Smoke Alarm
- ㉑ - CCTV camera
- ㉒ - Security Alarm sensor
- ㉓ - Security Alarm sensor
- ㉔ - Leo Fire Alarm call out
- ㉕ - Fire exit
- ㉖ - Fire exit sign
- ㉗ - Fire extinguishers x 2

NO	DESCRIPTION	QUANTITY	UNIT	REMARKS
1	Fire exit	1		
2	Fire Alarm main unit	1		
3	Smoke Alarm	1		
4	Leo Fire Alarm control	1		
5	Fire exit sign	1		
6	Fire exit sign	1		
7	CCTV Camera	1		
8	CCTV Camera	1		
9	Security Alarm sensor	1		
10	Security Alarm sensor	1		
11	CCTV camera	1		
12	Gas shut off emergency button	1		
13	CCTV camera	1		
14	Smoke Alarm	1		
15	Fire Blanket	1		
16	Fire Blanket	1		
17	Gas shut off emergency button	1		
18	Fire extinguishers x 2	2		
19	Fire exit sign	1		
20	Smoke Alarm	1		
21	CCTV camera	1		
22	Security Alarm sensor	1		
23	Security Alarm sensor	1		
24	Leo Fire Alarm call out	1		
25	Fire exit	1		
26	Fire exit sign	1		
27	Fire extinguishers x 2	2		

This page is intentionally left blank

-----Original Message-----

From: [REDACTED]
Sent: Monday, March 25, 2024 5:18 PM
To: Blackburn, Damon <Damon.blackburn@coventry.gov.uk>
Subject: Fwd: Objection

>
> Dear sir/madam
>
> Please find this my objection for the extended opening hours to provide
"refreshments" from the below business:-
>
> MTB Foods
> Burger Boi
> 48 Daventry Road
> Coventry
> CV3 5DP
>
> I am a local resident. Since the opening of Burger Boi, the following has occurred:-
>
> 1. An increased level of noise throughout the day and especially at night.
>
> 2. The constant illegal parking of vehicles accessing the venue is unacceptable
and a danger to local residents, children and the elderly. There have been several
near misses of people trying to cross the road safely due vehicles parking
dangerously. There has been an increase of road traffic accidents in this area due to
poor parking.
>
> 3. The level of waste containers, paper & bottles are constantly seen in the area
and in nearby gardens.
>
> I am opposing the request for the extended opening hours to access
"refreshments" due to my points mentioned above which will only increase to an
even more unacceptable level if approved.
>
> Also, we already have food outlets offering take out foods as well as a convenience
store offering "refreshments". I would not need to use anything other than what we
already have.
>
> Regards
> [REDACTED]

From: [REDACTED]
Sent: Monday, March 25, 2024 11:45 AM
To: Blackburn, Damon <damon.blackburn@coventry.gov.uk>
Subject: new premise application

Hi Mr Blackburn,

could you please take this email as a formal objection to the new premises application at Burger Boi(MTB foods limited) 48 Daventry road Coventry cv3 5dp.

I'm sure that you may have had some response to this already, my objection are highlighted below,

additional take-away delivery drivers would be noise and litter pollution, we as residents are currently plighted on a daily occurrence with inconsiderate parking across drives and yellow markings etc.. causing safety concerns.

opening up for an additional hour doesn't warrant business needs, just in fact causing harassment to local resident's.

please keep me informed on any meetings on this matter which or any notices in regards to this application.

kind Regards

[REDACTED]

Title: Extended Opening Hours, Burger Boi, Daventry Rd

Statement:

We the undersigned petition the Council to not extend the opening hours of Burger Boi from 23.00 to 00.00 Monday - Sunday

Justification:

This would have a detrimental effect on the residents in the surrounding area, Daventry Road is a residential area.

Currently with 23.00 closing activity does not just stop at 23.00, therefore extended to 00.00 activity would continue past midnight, this is not acceptable to local residents most of whom will be in bed at this time.

Originally 23.00 closing avoided late night disturbance by traffic, parking and loud voices, what is different now?

Submitted by: [REDACTED]











This Map is reproduced from the Ordnance Survey mapping with the permission of the controller of Her Majesty's Stationery Office © Crown Copyright. Unauthorised reproduction infringes Crown Copyright and may lead to prosecution or civil proceedings.



Burger Boi 48 Daventry Road



This page is intentionally left blank

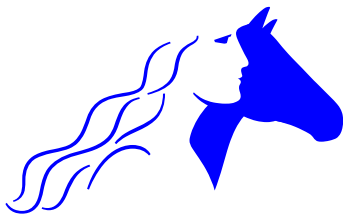

Coventry City Council

LICENSING ACT 2003

LICENSING SUB-COMMITTEE

HEARING PROCEDURE NOTE

1. The Members of the Sub-committee will enter the hearing room.
2. The Chair will introduce the Members of the Sub-committee and its supporting officers (normally a legal adviser and a minute taker) and will ask each of the parties (and their representatives) to identify themselves.
3. The Chair will ask if the parties have received and understood the procedure note (and in particular that cross-examination by the parties is not allowed) and whether anyone present would like the procedure explained further?
4. The Chair will confirm any relevant further documents the licensing authority has received before the hearing and will be considering, and will ask the parties whether there are any other documents they now wish to present (subject to the other parties' consent) and their reasons for doing so.
5. The Chair will ask if any party wishes to call witnesses in support of their case and their reasons for doing so.
6. The Licensing Officer will give a brief description of the application, confirm whether all relevant application formalities have been complied with and where relevant, that the authority has notified the parties of any points that the authority wanted clarification on at the hearing?
7. The Chair will invite the applicant/licensee/review applicant (or representative) to present their case (maximum 20 minutes).
8. The Chair will invite Members of the Sub-committee to ask the applicant/licensee/review applicant (or representative) questions.
9. The Chair will invite each objector/review review respondent (or representative) to present their case (maximum 20 minutes each)
10. The Chair will invite Members of the Sub-committee to ask each objector/review respondent (or representative) questions.
11. The Chair will invite each objector/review respondent (or representative) to sum up their case and if they wish, to comment on anything said by any other party (maximum 10 minutes).
12. The Chair will invite the applicant/licensee/review applicant to sum up their case and if they wish, to comment on anything said by any other party (maximum 10 minutes).

*[13. The Members of the Sub-committee will retire with their supporting officers to make their decision.

14 The Members of the Sub-committee and their supporting officers will return to the hearing room and the Chair will invite the Committee Solicitor to inform the meeting of the decision made, any facts relied on, the reasons for the decision and any specific legal advice given.

15. The Sub-committee's decision will be confirmed in a written Notice of Determination that will be issued to all parties within 5 working days of the determination.

* Where permitted by the Act, the Chair may close the meeting at this point and re-convene the meeting in private at a later date for the Sub-committee to make its decision.



Coventry City Council

Licensing Act 2003

Briefing Note 1 – Hearing to Consider a Premises Licence Application

Background

A Premises Licence is required before any licensable activity can take place on any land, vehicle or vessel and where that activity will not be covered by a Club Premises Certificate or a Temporary Event Notice. The application can be made by a living individual aged 18+ or by a corporation. The application must include an "operating schedule" and a plan of the premises. If it is intended to supply alcohol from the premises, the application must specify a "Designated Premises Supervisor" who will be the person having day-to-day responsibility for the premises. The "Operating Schedule" states the kinds of licensable activities that will be taking place on the premises, the proposed times of opening and the steps proposed to promote the four licensing objectives. Premises Licences remain in force indefinitely unless a time-limited licence has been requested.

A hearing is required because "relevant representations" (i.e. relevant to the licensing objectives) have been made by a "responsible authority" (i.e. police, fire or local government agencies) or any other person or both.

Section 182 Guidance (Apr 2018)

Particular reference should be made to Parts 9 and 10.

Local Statement of Licensing Policy (2016)

Particular reference should be made to Parts 4, 5, 6, 7

Human Rights Act

The hearing procedure and the availability of a statutory right of appeal comply with the Article 6 requirement to provide a fair hearing when determining the applicant's and objectors' civil rights. A decision to grant a licence will only be regarded as infringing the Article 8 rights of local residents/businesses if any noise/disturbance likely to be caused is of an extreme nature. Given the police powers to close premises in these circumstances this is unlikely to be an issue at application stage.

The Sub-committee's powers

Having heard from the applicant and the other parties the sub-committee may:

- (a) grant the application; or
- (b) grant the application with additional or modified conditions; or
- (c) exclude one or more licensable activities from taking place on the premises; or
- (d) where the Police have objected to the proposed DPS, refuse to agree to the proposed "designated premises supervisor"; or
- (e) reject the application outright

Rights of Appeal

An aggrieved applicant can appeal to Coventry Magistrates' Court against any decision made by the sub-committee that falls within (b) – (e) above. An aggrieved objector can also appeal against the grant of an application.

Monitoring/Enforcement

If an application is approved, monitoring and enforcement of Premises Licence conditions will be carried out in accordance with the Licensing Enforcement Policy.